

# TC/TCM Two-stage Liquid Ring Vacuum Pumps

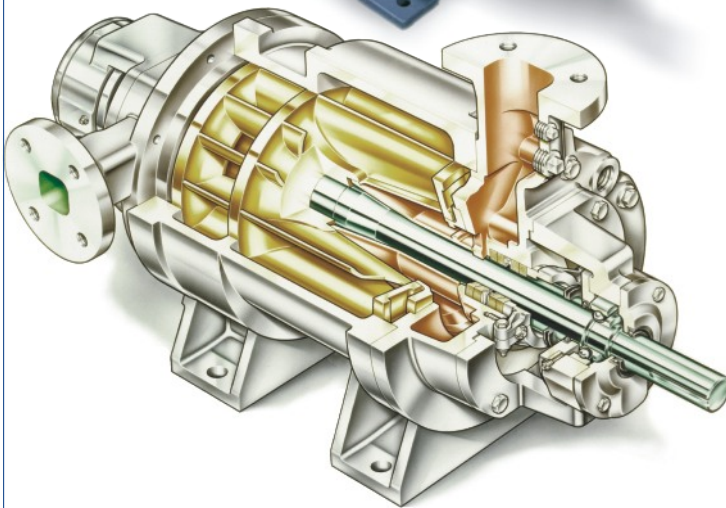

The TC/TCM liquid ring vacuum pumps were created for the chemical, petrochemical and power industries.

These pumps with their integral two stage rotors are able to condense vapors that come off the process and to recover or dispose of them.

The result is a highly reliable and efficient vacuum pump.

Features	Benefits
Integral two-stage impeller	High reliability, can attain high vacuum without additional components
V-belt or flexible coupling drive	Numerous installation options
Offered in ductile iron or in stainless steel	High durability and corrosion resistance
Shrouded rotor blades	For strength and reliability
Single or double mechanical seal available	Ability to select the proper sealing option

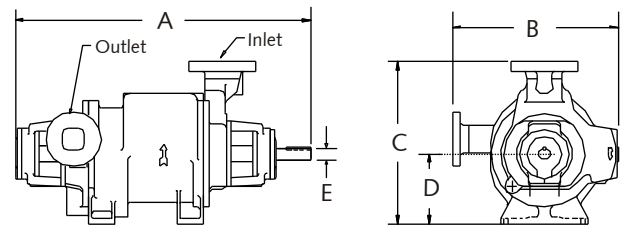

TC/TCM 1-5

### Dimensions mm in blue

Pump	A	B	C	D	E	Inlet	Outlet
TCM 1	31.1 791	15.6 397	15.5 394	6.5 165	1.4 35	2 in. FLG. 50mm FLG.	2 in. FLG. 50mm FLG.
TCM 2	36.9 937	17.1 435	17.8 451	7.9 200	1.5 38	2 in. FLG. 50mm FLG.	2 in. FLG. 50mm FLG.
TCM 3	38.6 981	17.1 435	17.8 451	7.9 200	1.5 38	2 in. FLG. 50mm FLG.	2 in. FLG. 50mm FLG.
TC 5	40.3 1022	22.5 572	22 559	9.5 241	1.6 41	4 in. FLG. 100mm FLG.	3 in. FLG. 80mm FLG.
TC 7	51 1282	28 702	26 654	13 330	2.4 60	6 in. FLG. 150mm FLG.	4 in. FLG. 100mm FLG.
TC 11	81 2060	40 1005	43 1080	19 480	3.7 95	8 in. FLG. 200mm FLG.	6 in. FLG. 150mm FLG.

All dimensions are approximate

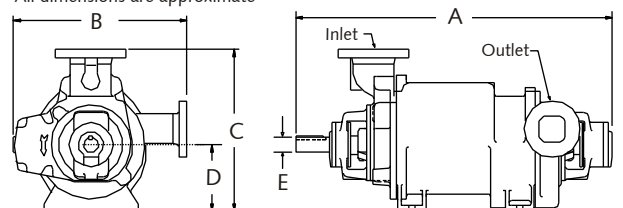

TC 7-11

### Performance

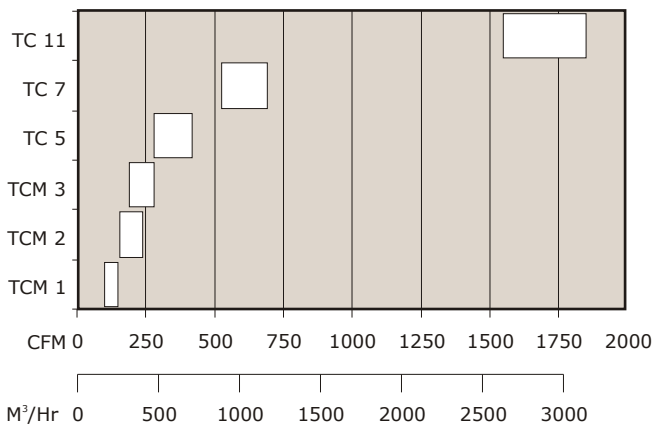

Gardner Denver Liquid Ring Pump Division

9 Trefoil Drive, Trumbull, CT 06611 · phone: +1 800 553 NASH · fax: +1 203 459 3988 · email: nash@gardnerdenver.com  
GardnerDenverNash.com